

VISTA PARZIALE
(Partial view)

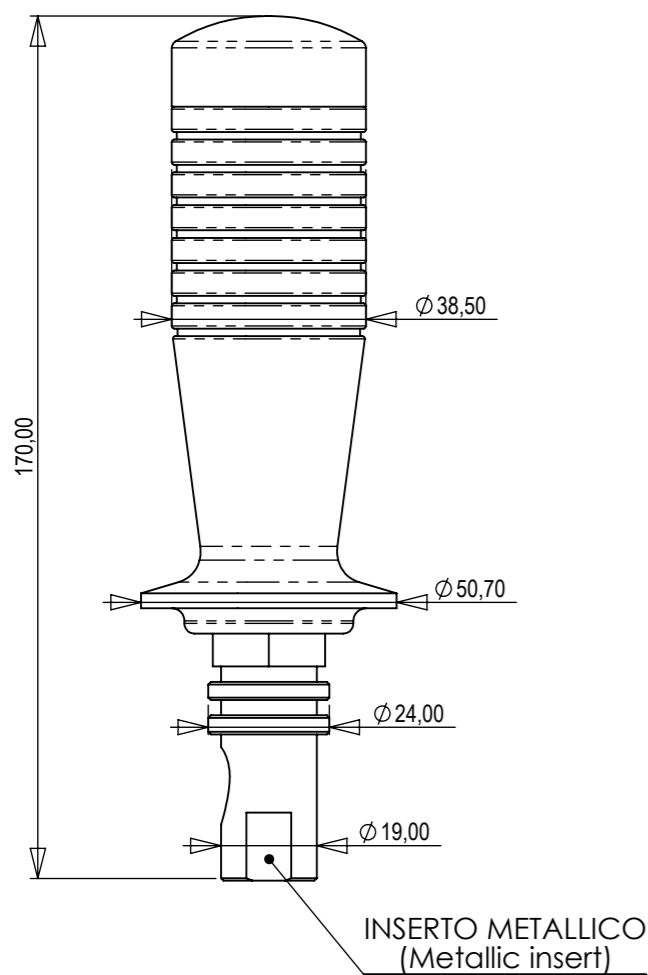

VISTA PARZIALE
(Partial view)

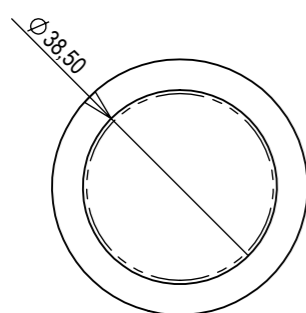

SCHEMA ELETTRICO
(Electric scheme)

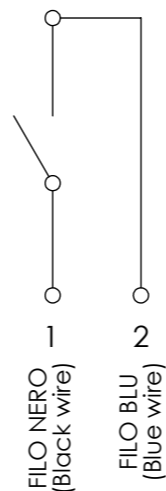

		MICROSWITCH SPECIFICATIONS								
Item	Rated Voltage (V)	Non-Inductive load (A)				Inductive load (A)				Inrush current
		Resistive load		Lamp load		Inductive load		Motor load		
Type		NC	NO	NC	NO	NC	NO	NC	NO	
	250 VAC	16		2		10		3		
	8VDC	16		4		10		6		40 A
16A	30VDC	10		4		10		4		max.
	125VDC	0,6		0,1		0,6		0,1		
	250VDC	0,3		0,05		0,3		0,05		

DETTAGLIO FILI ELETTRICI
SCALA 1,5 : 1
(detail electric wires scale 1,5 : 1)

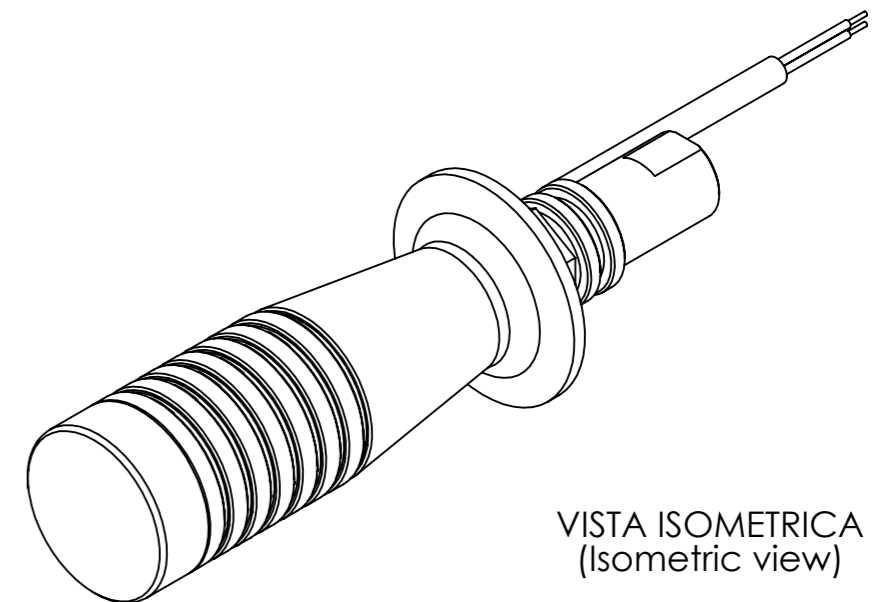
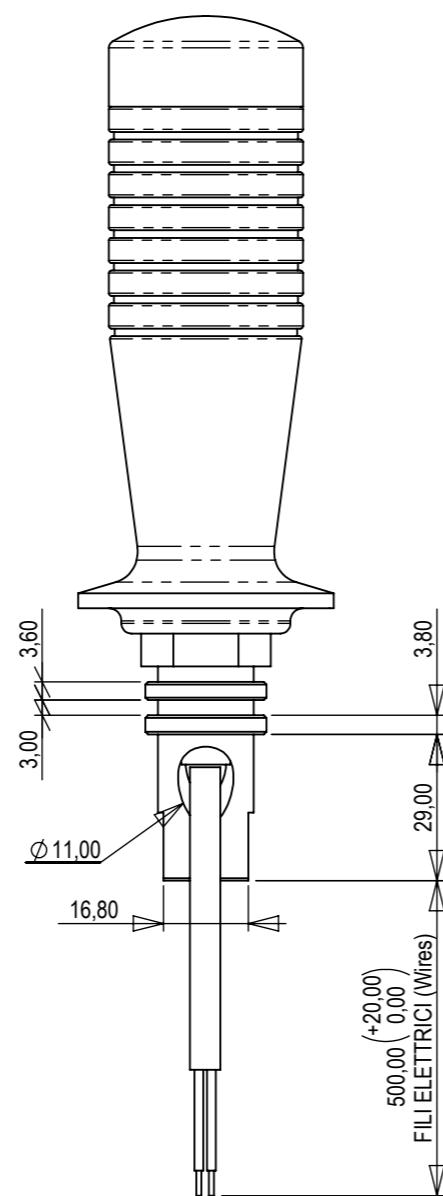
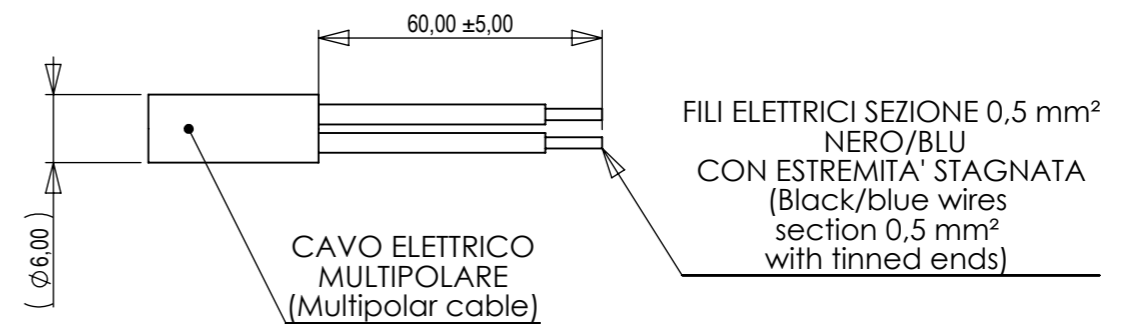

C	21/11/17		modif.: repl. anti-abrasion sheath + shrink sheath + 2 electric wires 0,5 mm ² with multip. cable; R.d.M. n° 1274/17.
B	08/04/10		modif.: updated drawing and notes; R.d.M. n° 761/10.
A	01/06/04		modif.: add detail electrical wire and tolerance on wires lenght.
MODIFICA (mod)	DATA (date)	FIRMA UFF. TECN. (technical sign)	DESCRIZIONE DELLA MODIFICA (mod description)

INDEMAR INDUSTRIALE Via Costalovaia 5 16012 Busalla (GENOVA) Tel. 010-96.48.712 / Fax 010-96.48.057 http://www.indemar.it/ mailto: info@indemar-industriale.com	DISEGNATO DA (drawn by) TRAVERSO CONTROLLATO DA (checked by) REBOTARO	FIRMA (sign) CATEGORIA MERCEOLOGICA (commodity sector) IC CODICE CLIENTE (customer code)	DESCRIZIONE (description): KNOB WITH 1 BUTTON AND SPECIAL HUB	NUMERO DI DISEGNO (drawing number): 3546 FOGLIO 1 DI 1 (sheet) FILE: 3546.drwslid
	FORMATO FOGLIO (sheet size) A3	RIPRODUZIONE VIETATA (all rights reserved)	SCALA: 1:1,5 (scale) PROIEZIONE EUROPEA (european projection)	EDIZIONE (issue): 28.10.2002